

# HEDRAD

INFINITE POSSIBILITIES

Watch that  
empty terrace  
transform into a  
work-from-home  
studio in days!

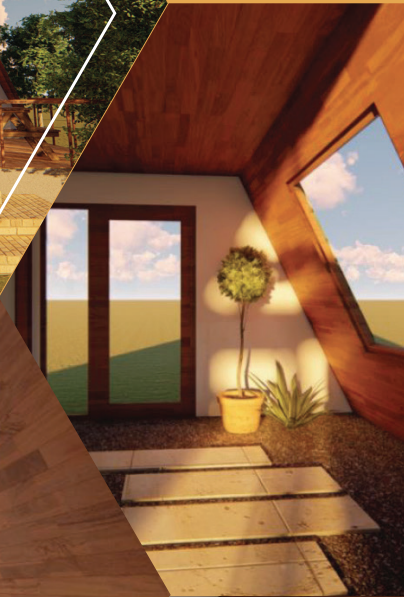
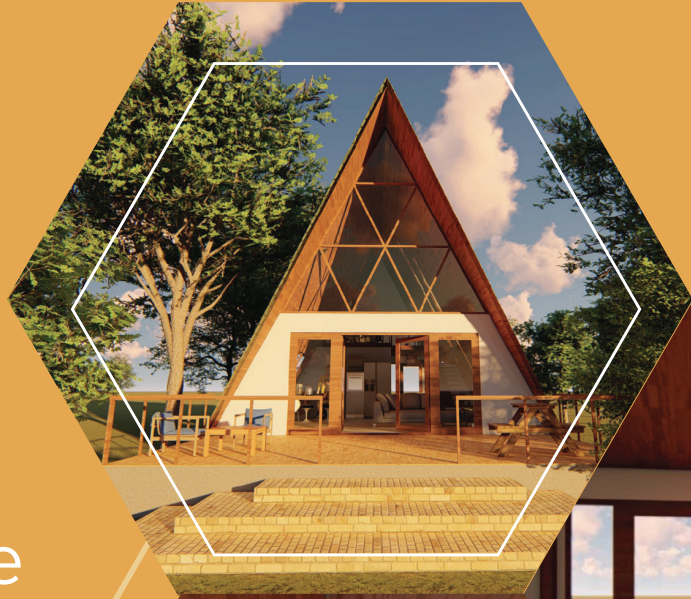

PRESENTING  
EcoWasp Terrace Homes.

# The experts in **Paper Honeycomb Superstructure** are here to make your Terrace Home.

## Introducing **EcoWasp** Technology, an eco-friendly standard

Strategically aligned paper hexagons create a honeycomb superstructure that gets strength and stability like concrete. It is nature's own secret to give us the most durable structure known.

Our Labs has crafted this structure close to perfection with over a decade of research. The honeycomb is further enhanced with precision Joinery solutions for composite materials to produce a variety of panels. These integrated panels are the building blocks that craft your home like a dream.



Office Space of 170 sft,  
In Domlur, Bangalore

Built in 2021 in 7 days



Terrace studio home of 150 sft,  
In Austin Town, Bangalore

Built in 2020 in 15 days



A-frame cabin in Sakleshpur,  
Surrounded by greenery

Built in 2021 in 15 days

*Affordable homes  
starting at just*  
**INR 1100 / Sq. Ft**

# Realise your Work-from-Home Space at an incredible cost and time.

Our panels are the soul of beauty,  
strength and durability.

No more worries on construction  
mess, time or design possibilities.

WORK-FROM-HOME STUDIO OR  
QUARANTINE SPACE.

Anything you want can  
be built in no time.

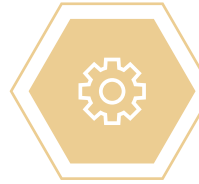

EASY TO ASSEMBLE,  
LIGHTWEIGHT  
PANELS



CONSTRUCTION  
COMPLETED  
IN DAYS



DURABLE WITH  
PROVEN LIFESPAN  
OF 25+ YEARS



MOISTURE, FUNGAL  
AND TERMITE  
RESISTANT



HIGH THERMAL  
INSULATION FOR  
COOL HOMES



ECO-FRIENDLY  
PANELS



FIRE-PROOF  
HOMES



HIGH  
WINDSPEED  
TOLERANCE

# HEDRAD

INFINITE POSSIBILITIES

## **EcoWasp Technology is the base for Aerospace too.**

A unique alternative with extraordinary benefits, Honeycomb structures are used in the Space and Aviation industry for superior strength and safety.

Our Paper Honeycomb Superstructure is the challenger to monolithic materials like stone, concrete and steel. It's also a replacement for conventional foam cores. Give your dream terrace home the advantage of the new light-weight, hyper-strength, super-material in construction design with EcoWasp technology.

For more information visit us at: [www.hedrad.in](http://www.hedrad.in)

Hours: 9.30 am to 6.00 pm     [connect@hedrad.in](mailto:connect@hedrad.in)     0-87923-49693

---

1-B Anugriha, Service Road, Domlur, Bangalore - 560071